

# Expansion Screws

## Standard Expansion Screws



600-400-10	1 piece
600-400-30	10 pieces

CE

← 11 mm →

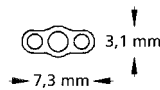
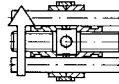

### rematitan®-Expansion Screw, Medium

Made of pure titanium.

#### Skeleton design

For transversal expansion and distalization in upper and lower arch. Pearl-blue plastic directional arrows. Holes in body of screws for better retention in acrylic. Built-in stops prevent screws from coming apart.

**Maximum expansion: 7.5 mm**

**4 x 1/4 turn = 0.80 mm**



600-300-30	10 pieces
600-300-60	100 pieces

CE

← 10 mm →

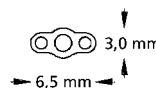
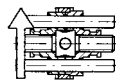

### Expansion Screw, Mini

#### Skeleton design

For transversal expansion and distalization in the lower arch or for especially narrow upper arches. White plastic directional arrows. Holes in body of screws for better retention in acrylic. Built-in stops prevent screws from coming apart.

**Maximum expansion: 6.5 mm**

**4 x 1/4 turn = 0.70 mm**



600-301-30	10 pieces
600-301-60	100 pieces

CE

← 11 mm →

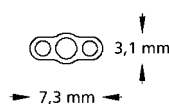
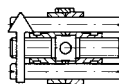

### Expansion Screw, Medium

#### Skeleton design

For transversal expansion and distalization in the upper and lower arch. Neon yellow plastic directional arrows. Holes in body of screws for better retention in acrylic. Built-in stops prevent screws from coming apart.

**Maximum expansion: 7.5 mm**

**4 x 1/4 turn = 0.80 mm**



600-302-30	10 pieces
600-302-60	100 pieces

CE

← 11,5 mm →

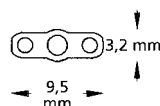
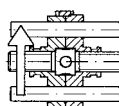

### Expansion Screw, Maxi

#### Skeleton design

For transversal expansion in the upper arch. Neon yellow plastic directional arrows. Holes in body of screws for better retention in acrylic. Built-in stops prevent screws from coming apart.

**Maximum expansion: 7.5 mm**

**4 x 1/4 turn = 0.80 mm**

## Standard Expansion Screws

### Expansion Screw, Magnum

#### Skeleton design

Extra strong, for transversal expansion in the upper arch and bimaxillary functional gnatho-orthopedic appliances. Neon yellow plastic directional arrows. Holes in body of screws for better retention in acrylic. Built-in stops prevent screws from coming apart.

**Maximum expansion: 11 mm**

**4 x 1/4 turn = 0.80 mm**

600-303-30	10 pieces
600-303-60	100 pieces

CE

← 14,5 mm →

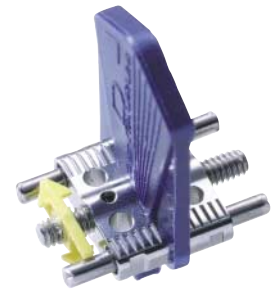
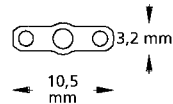
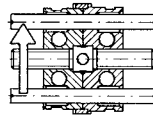

### Trapezoidal Expansion Screw

#### Skeleton design

For narrow maxillas and as activation screw for bimaxillary functional gnatho orthopedic appliances. Neon yellow plastic directional arrows.

**Maximum expansion: 5 mm**

**4 x 1/4 turn = 0.80 mm**

600-310-30	10 pieces
------------	-----------

CE

← 14,5 mm →  
← 11,5 mm →

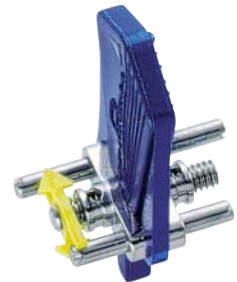
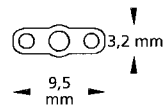
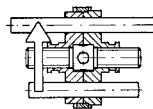

## Special Screws



600-502-10	1 piece
600-502-30	10 pieces
600-502-60	100 pieces

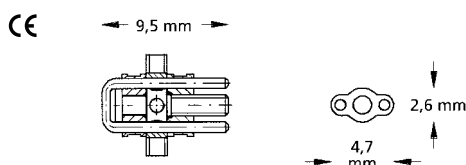

### Sectional Screw, Mini

#### Straight guide pins

For movement of individual teeth. Arrow indicating the opening direction.

**Maximum expansion: 4 mm**

4 x 1/4 turn = 0.35 mm



600-503-10	1 piece
600-503-30	10 pieces
600-503-60	100 pieces

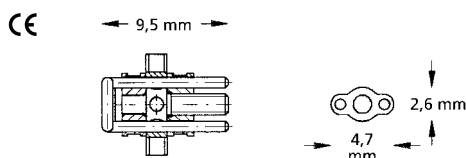

### Sectional Screw, Mini

#### Angulated guide pins facing down

For movement of individual teeth. Arrow indicating the opening direction.

**Maximum expansion: 4 mm**

4 x 1/4 turn = 0.35 mm



600-500-10	1 piece
600-500-30	10 pieces
600-500-60	100 pieces

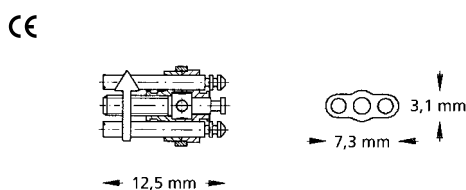

### Sectional Screw, Medium

#### Straight guide pins

Neon yellow plastic directional arrows. Holes in body of screw for better retention in acrylic. Built in stops prevent screws from coming apart.

**Maximum expansion: 6 mm**

4 x 1/4 turn = 0.40 mm



600-501-10	1 piece
600-501-30	10 pieces
600-501-60	100 pieces

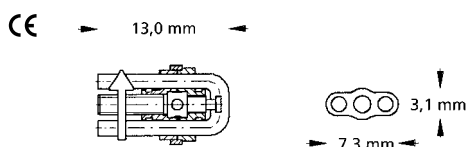

### Sectional Screw, Medium

#### Angulated guide pins facing down

Neon yellow plastic directional arrows. Guide pins angulated for better placement in acrylic. Holes in body of screws for better retention in acrylic. Built-in stops prevent screws from coming apart.

**Maximum expansion: 6 mm**

4 x 1/4 turn = 0.40 mm

### Retraction Screw, Extra Mini

#### Straight

U-shaped guide pins. For space closing and movement of individual teeth. Arrow indicating the opening direction.

**Maximum retraction: 3 mm**  
 $4 \times \frac{1}{4}$  turn = 0.40 mm

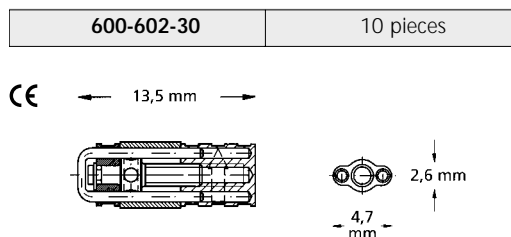

### Retraction Screw, Mini

#### Straight

U-shaped guide pins. For space closing and movement of individual teeth. Arrow indicating the opening direction.

**Maximum retraction: 2.5 mm**  
 $4 \times \frac{1}{4}$  turn = 0.40 mm

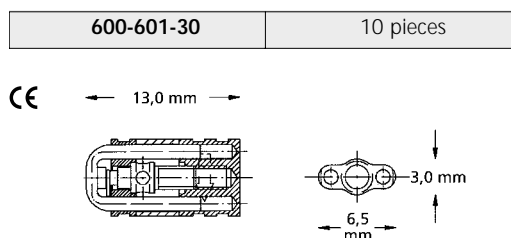

### Retraction Screw, Medium

#### Straight

U-shaped guide pins. For space closing and movement of individual teeth. Arrow indicating the opening direction.

**Maximum retraction: 4.5 mm**  
 $4 \times \frac{1}{4}$  turn = 0.40 mm

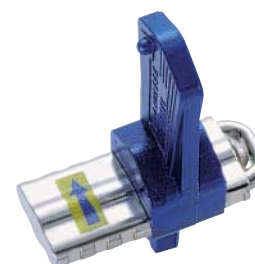
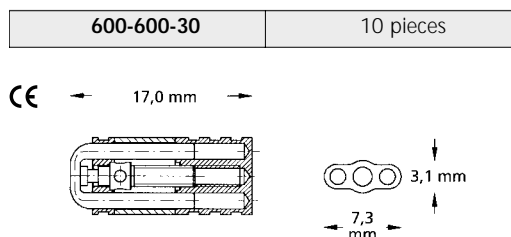

### Three Dimensional Screw

#### (Bertoni)

Combination transversal and protrusion screw for Y-plates. Strengthened guides. Arrow indicating the opening direction.

**Maximum expansion: 4 mm per segment**  
 $4 \times \frac{1}{4}$  turn = 0.35 mm

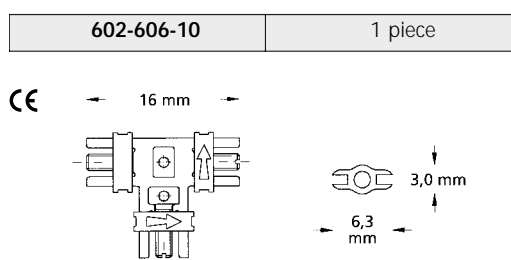

### Three Dimensional Screw

#### (Bertoni)

Three independently controlled movements. Strengthened guides for Y-plates. Arrow indicating the opening direction.

**Maximum expansion: 4 mm per segment**  
 $4 \times \frac{1}{4}$  turn = 0.35 mm

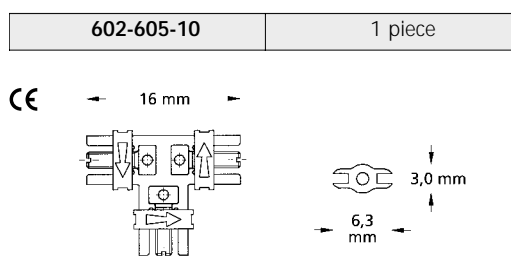

## Special Screws



602-604-10	1 piece
------------	---------

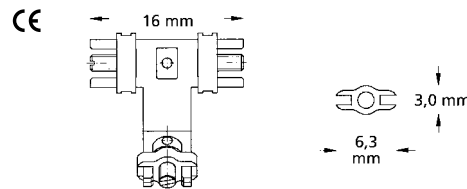

### Three Dimensional Screw

(Steiner)

The separately adjustable central connector allows individual fitting to different palate shapes. Strengthened guides. Combination transversal and protrusion screw for Y-plates. Arrow indicating the opening direction.

**Maximum expansion: 4 mm per segment**

4 x 1/4 turn = 0.35 mm



606-600-00	1 piece
606-600-30	10 pieces



### Fan-type Expansion Screw

For sectional expansion of maxillary anterior. Plate sections are opened fanwise. Arrow indicating the opening direction.

**Maximum expansion: 7 mm**

4 x 1/4 turn = 0.80 mm



606-701-00	1 piece
606-701-30	10 pieces

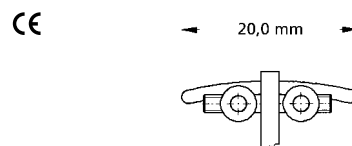

### Mandibular Bow Screw

(Mueller)

For lateral and sagittal anterior expansion of the mandible. Arrow indicating the opening direction.

**Maximum expansion: 5 mm**

4 x 1/4 turn = 0.80 mm



600-000-00	1 Assortment
------------	--------------

CE

### "Flexible" Forward Thrust Double Plate System (Schaneng)

For the treatment of distal malocclusions. The flexible forward thrust double plate system is a new development and differs from conventional systems in the flexibility of the intermaxillary elements.

**Starter set consisting of:**

- 3 x Screws with guide ridge for forward thrust double plate Order No. 600-001-00
- 1 x Adapter, narrow Order No. 600-003-00
- 1 x Adapter, wide Order No. 600-004-00
- 1 x Locating template Order No. 600-005-00
- 1 x Instructions

### "Flexible" Forward Thrust Double Plate System (Schaneng) Guide Ridge

With palatal expansion screw.  
Length of Guide Ridge: 14 mm

600-001-00	1 piece
600-001-30	10 pieces

CE



### "Flexible" Forward Thrust Double Plate System (Schaneng) Guide Ridge

Without palatal expansion screw.  
Length of Guide Ridge: 14 mm

600-002-00	1 piece
600-002-30	10 pieces

CE



### "Flexible" Forward Thrust Double Plate System (Schaneng) Guide Ridge Adapter

To produce the diagonal level in the lower jaw.

Adapter, narrow

Width: 14 mm

600-003-00	10 pieces
------------	-----------

CE



Adapter, wide

Width: 18 mm

600-004-00	10 pieces
------------	-----------



### Locating Template (Schaneng)

Made of stainless steel

The locating template supplied with the system ensures that the guide ridge slides properly on the lingual plate at a 60° angle.

600-005-00	1 piece
------------	---------



## Special Screws

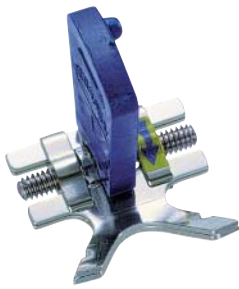

600-610-00	1 piece
------------	---------

CE

← 14,5 mm →

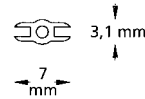
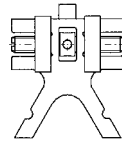

### Expansion Screw for Split Activator

For separate expansion of upper and lower arches. Arrow indicating the opening direction.

**Maximum expansion: 7 mm**  
**4 x 1/4 turn = 0.80 mm**



603-000-00	1 piece
------------	---------

CE

← 14,0 mm →

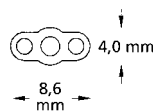
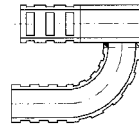

### Norwegian Plate Screw

(Weise)

Sturdy screw for Norwegian plates and activators. Arrow indicating the opening direction.

**Maximum expansion: 5 mm**  
**4 x 1/4 turn = 0.90 mm**



602-806-10	1 piece
602-806-30	10 pieces

CE<sup>0483</sup>

### Variety Expansion Screw

**Screw with straight retention legs**

For the fixed appliance technique. Can be widely used in the upper and lower jaw, for distalisation, mesialisation of posterior teeth, or for osseous distraction in the lower jaw.

Also for palatal expansion.

- Small dimensions with maximum expansion
- Solder free
- Break resistant retention legs and stable guidance throughout the entire expansion
- The integrated spindle friction prevents unwanted turning back
- Permanently laser marked arrow on the body of the screw indicates the opening direction and maximum expansion
- Screw can be tied down once desired expansion has been reached

With Safety Key

**Screw: 9.6 mm**

**Maximum expansion: 12 mm**

**4 x 1/4 turn = 0.80 mm**

### Hyrax® Titanium 14/12

#### Special Expansion Screw with straight retention legs made of pure titanium

For mid-palatal suture separations by means of fixed appliances without the need for acrylic plates. Can be laser welded with titanium framework or Titanium Direct Bond Pads Order No. 799-210-00.

With Safety Key

**Screw: 14.4 mm**

**Maximum expansion: 12 mm**

**4 x 1/4 turn = 0.80 mm**

602-810-10	1 piece
602-810-30	10 pieces

CE 0483

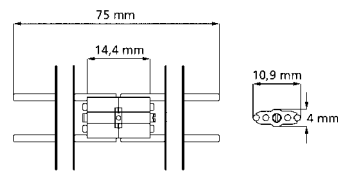

### Titanium Direct Bond Pads

Anatomically contoured. The titanium bonding bases are laser structured for the direct bond technique, specifically for the direct bonding of RPE appliances in conjunction with the Hyrax® Titanium 14 / 12.

799-210-00	10 pieces
------------	-----------

CE 0483



### Hyrax® II - 9/7

#### Special Expansion Screw with straight retention legs

For mid-palatal suture separations by means of fixed appliances without the need for acrylic plates.

- Built-in stops prevent the screws from coming apart once maximum expansion has been obtained
- Small dimensions with maximum expansion
- Solder free
- Break resistant retention legs, stable guidance throughout complete expansion
- The integrated spindle friction prevents unwanted turning back
- Permanently laser marked arrow on the body of the screw indicates the opening direction and maximum expansion
- Screw can be tied down once desired expansion has been reached

With Safety Key

**Screw: 9.4 mm**

**Maximum expansion: 7 mm**

**4 x 1/4 turn = 0.80 mm**

602-800-10	1 piece
602-800-30	10 pieces

CE 0483

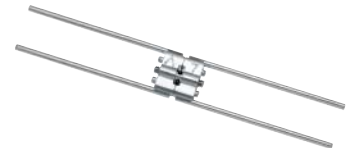
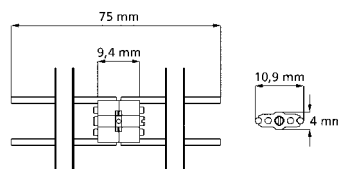



## Special Screws



602-801-10	1 piece
602-801-30	10 pieces

CE 0483

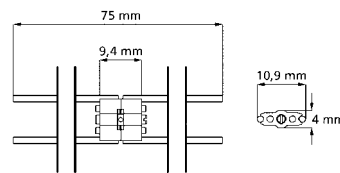

### Hyrax® II - 9/7

#### Special Expansion Screw with bent retention legs

For mid-palatal suture separations by means of fixed appliances without the need for acrylic plates.

- Built-in stops prevent the screws from coming apart once maximum expansion has been obtained
- Small dimensions with maximum expansion
- Solder free
- Break resistant retention legs, stable guidance throughout complete expansion
- The integrated spindle friction prevents unwanted turning back
- Permanently laser marked arrow on the body of the screw indicates the opening direction and maximum expansion
- Screw can be tied down once desired expansion has been reached

With Safety Key

**Screw: 9.4 mm**

**Maximum expansion: 7 mm**

**4 x 1/4 turn = 0.80 mm**

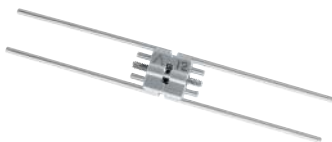

602-804-10	1 piece
602-804-30	10 pieces

CE 0483

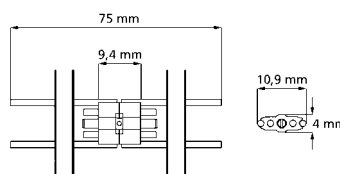

### Hyrax® II - 9/12

#### Special Expansion Screw with straight retention legs

For mid-palatal suture separations by means of fixed appliances without the need for acrylic plates.

- Built-in stops prevent the screws from coming apart once maximum expansion has been obtained
- Small dimensions with maximum expansion
- Solder free
- Break resistant retention legs, stable guidance throughout complete expansion
- The integrated spindle friction prevents unwanted turning back
- Permanently laser marked arrow on the body of the screw indicates the opening direction and maximum expansion
- Screw can be tied down once desired expansion has been reached

With Safety Key

**Screw: 9.4 mm**

**Maximum expansion: 12 mm**

**4 x 1/4 turn = 0.80 mm**

### Hyrax® II - 9/12

#### Special Expansion Screw with bent retention legs

For mid-palatal suture separations by means of fixed appliances without the need for acrylic plates.

- Built-in stops prevent the screws from coming apart once maximum expansion has been obtained
- Small dimensions with maximum expansion
- Solder free
- Break resistant retention legs, stable guidance throughout complete expansion
- The integrated spindle friction prevents unwanted turning back
- Permanently laser marked arrow on the body of the screw indicates the opening direction and maximum expansion
- Screw can be tied down once desired expansion has been reached

602-805-10	1 piece
602-805-30	10 pieces

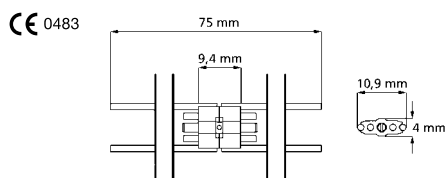

With Safety Key

**Screw: 9.4 mm**

**Maximum expansion: 12 mm**

**4 x 1/4 turn = 0.80 mm**

### Hyrax® II - 12/10

#### Special Expansion Screw with straight retention legs

For mid-palatal suture separations by means of fixed appliances without the need for acrylic plates.

- Built-in stops prevent the screws from coming apart once maximum expansion has been obtained
- Small dimensions with maximum expansion
- Solder free
- Break resistant retention legs, stable guidance throughout complete expansion
- The integrated spindle friction prevents unwanted turning back
- Permanently laser marked arrow on the body of the screw indicates the opening direction and maximum expansion
- Screw can be tied down once desired expansion has been reached

602-808-10	1 piece
602-808-30	10 pieces

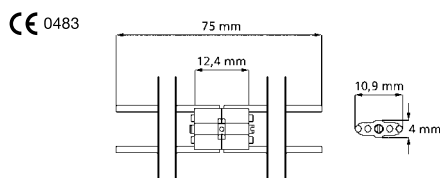

With Safety Key

**Screw: 12.4 mm**

**Maximum expansion: 10 mm**

**4 x 1/4 turn = 0.80 mm**

## Special Screws



602-802-10	1 piece
602-802-30	10 pieces

CE 0483

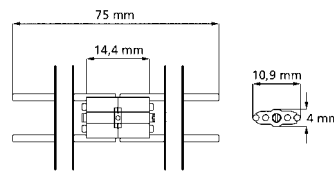

### Hyrax® II - 14/12

#### Special Expansion Screw with straight retention legs

For mid-palatal suture separations by means of fixed appliances without the need for acrylic plates.

- Built-in stops prevent the screws from coming apart once maximum expansion has been obtained
- Small dimensions with maximum expansion
- Solder free
- Break resistant retention legs, stable guidance throughout complete expansion
- The integrated spindle friction prevents unwanted turning back
- Permanently laser marked arrow on the body of the screw indicates the opening direction and maximum expansion
- Screw can be tied down once desired expansion has been reached

With Safety Key

**Screw: 14.4 mm**

**Maximum expansion: 12 mm**

**4 x 1/4 turn = 0.80 mm**



602-803-10	1 piece
602-803-30	10 pieces

CE 0483

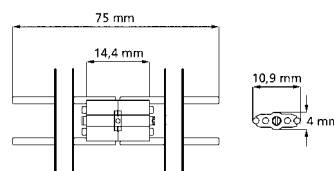

### Hyrax® II - 14/12

#### Special Expansion Screw with bent retention legs

For mid-palatal suture separations by means of fixed appliances without the need for acrylic plates.

- Built-in stops prevent the screws from coming apart once maximum expansion has been obtained
- Small dimensions with maximum expansion
- Solder free
- Break resistant retention legs, stable guidance throughout complete expansion
- The integrated spindle friction prevents unwanted turning back
- Permanently laser marked arrow on the body of the screw indicates the opening direction and maximum expansion
- Screw can be tied down once desired expansion has been reached

With Safety Key

**Screw: 14.4 mm**

**Maximum expansion: 12 mm**

**4 x 1/4 turn = 0.80 mm**

### Piston Spring Screws, Assortment

Complete assortment of piston spring screws and accessories.

Piston spring screws for the movement of individual teeth. These screws exert a constant, elastic and easily controllable pressure on the tooth to be moved. The compact size allows them to be easily built into appliances.

Treatment is started with the 4 mm screw, which is exchanged for the 6 mm screw and finally the 8 mm screw as the tooth in question is moved.

#### Contents:

- 10 x Piston spring screws, length 4 mm  
Order No. 609-004-00
- 10 x Piston spring screws, length 6 mm  
Order No. 609-006-00
- 10 x Piston spring screws, length 8 mm  
Order No. 609-008-00
- 10 x Positioning screws  
Order No. 609-100-00
- 10 x Serrated housing nuts  
Order No. 609-200-30
- 1 x Reamer Order No. 609-300-00
- 1 x Screw driver Order No. 609-400-00
- 1 x Instructions

4 x 1/4 turn = 0.35 mm

609-500-00	1 Assortment
------------	--------------

CE

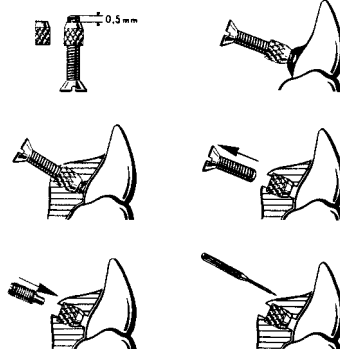

### Piston Spring Screws

For the movement of individual teeth. These screws exert a constant, elastic and easily controllable pressure on the tooth to be moved. Their compact size allows them to be easily built into appliances.

4 x 1/4 turn = 0.35 mm

Length: 4 mm

609-004-00	10 pieces
------------	-----------

CE



4 x 1/4 turn = 0.35 mm

Length: 6 mm

609-006-00	10 pieces
------------	-----------

CE



4 x 1/4 turn = 0.35 mm

Length: 8 mm

609-008-00	10 pieces
------------	-----------

CE



## Special Screws



609-100-00	10 pieces
------------	-----------

CE

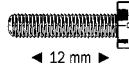

### Positioning Screw

For piston spring screws.

To position the piston spring screw into the acrylic.

Length: 12 mm



609-200-30	10 pieces
------------	-----------

CE



### Serrated Housing Nut

For piston spring screws.

To position into acrylic or to weld onto wire elements.

Length: 3 mm



609-300-00	1 piece
------------	---------

### Reamer

For piston spring screws.



609-400-00	1 piece
------------	---------

### Screw Driver

For piston spring screws.

To activate the piston spring screw.

### Arrows to Indicate the Opening Direction

For Expansion Screws.

Color: yellow

611-130-00	50 pieces
------------	-----------



Color: white

611-131-00	50 pieces
------------	-----------



Color: pearl-blue

611-132-00	50 pieces
------------	-----------



### Universal Bending Key

Easy bending of the retention legs of all Hyrax®, Variety and Hyrax® Titanium screws without the use of any additional pliers (leverage principle).

611-122-00	1 piece
------------	---------



### Safety Key

Can be used with all Dentaurem Hyrax® and Variety screws. For activation of the expansion screws by the patient in Hyrax® and Variety fixed appliances.

611-120-00	10 pieces
------------	-----------

CE



### Expansion Screw Key

#### Straight, small, standard

Can be used with all Dentaurem expansion screws. Stainless steel-rustfree. To activate all expansion screws in removable appliances. Outside of the mouth.

611-115-00	1 piece
611-115-60	100 pieces

CE



### Expansion Screw Key

#### Large, with elongated handle

Can be used with all Dentaurem expansion screws. Stainless steel-rustfree. To activate all expansion screws in removable appliances. Outside of the mouth.

611-116-00	1 piece
------------	---------

CE



## Accessories



043-720-00	1 piece
------------	---------

### Wedge Ruler

**Can be sterilized**

For checking the opening of appliances.



612-000-00	1 Set
------------	-------

CE

### Expansion Screw Sample Kit

Filled with 29 expansion screws that are currently available, plus 3 expansion screw keys.

**1 Set = 32 pieces**



163-602-01	10 pieces
------------	-----------

### Appliance Container, Mini

The mini version is especially suitable for single appliances and oral screens, such as the Ulmer Model.

Made of durable plastic.

**Color: pearl-blue**



163-603-01	10 pieces
------------	-----------

**Color: neon-pink**



163-604-01	10 pieces
------------	-----------

**Color: neon-yellow**



163-605-01	10 pieces
------------	-----------

**Color: neon-orange**

### Appliance Container, Mini

The mini version is especially suitable for single appliances and oral screens, such as the Ulmer Model.

Made of durable plastic.

**Color: neon-green**

163-606-01	10 pieces
------------	-----------



### Appliance Container, Maxi

The maxi version is especially suitable for bimaxillary appliances, such as activator, bionator.

Made of durable plastic.

**Color: pearl-blue**

163-702-01	10 pieces
------------	-----------



**Color: neon-pink**

163-703-01	10 pieces
------------	-----------



**Color: neon-yellow**

163-704-01	10 pieces
------------	-----------



**Color: neon-orange**

163-705-01	10 pieces
------------	-----------



**Color: neon-green**

163-706-01	10 pieces
------------	-----------





## Accessories



163-707-01

10 pieces

### Appliance Container, Maxi

The maxi version is especially suitable for bimaxillary appliances, such as activator, bionator.

Made of durable plastic.

**Color: black**



163-708-01

10 pieces

**Color: white-flecked**



163-802-01

10 pieces

### Appliance Container, Magnum

The magnum version is especially suitable for extremely large Fraenkel appliances, orthodontic appliances for adult treatment, or dentures.

Made of durable plastic.

**Color: pearl-blue**



163-800-00

25 pieces

### Cords for Appliance Containers

For attachment to belt.

**Color: neon**

